

TOPCON BIFACIAL MODULE SEMI+SMBB

SL5N144 | 570 WATT

ELECTRICAL DATA	STC	NMOT
Rated Power In Watts-Pmax (Wp)	570	429
Maximum Power Voltage-Vmpp (V)	42.99	40.15
Maximum Power Current-Impp (A)	13.26	10.70
Open Circuit Voltage-Voc (V)	50.97	48.51
Short Circuit Current-Isc (A)	14.08	11.27
Module Efficiency (%)	22.06%	/

STC: Irradiation 1000 W/m², Cell Temperature 25°C, Air Mass AM1.5 according to EN 60904-3.
NOCT: Irradiation: 800 W/m², ambient temperature: 20°C, air mass: 1.5, wind speed 1 m/s

Electrical Characteristics With Different Rear Side Power Again (Reference To 580w Front)					
Pmax gain (%)	5%	10%	15%	20%	25%
Maximum Power (Pmax/W)	599	627	656	684	713
Maximum Power Voltage (Vmpp/V)	42.99	42.99	42.99	42.99	42.99
Maximum Power Current (Impp/A)	13.93	14.59	15.25	15.91	16.58

MECHANICAL CHARACTERISTICS	
Solar Cells	Monocrystalline N-type, SMBB
Cell Configuration	144 cells (6 x 12 x 2)
Module Dimensions	2279*1134*30 mm
Weight	32.0 kg
Glass	2.0mm Tempered ARC Glass
Back Sheet	2.0mm Glass
Frame	Anodized Aluminium Alloy, Silver
J-Box	IP68, 3 bypass diodes
Cables	4.0mm ² , (+) 380mm, (-) 380mm or customized length
Connector	MC4 Compatible

TEMPERATURE & MAXIMUM RATINGS	
Nominal Module Operating Temperature (NMOT)	44±2°C
Temperature Coefficient of VOC	-0.25% / °C
Temperature Coefficient of ISC	0.045% / °C
Temperature Coefficient of PMAX	-0.30% / °C
Operational Temperature	-40°C~+85°C
Maximum System Voltage	1500VDC
Max Series Fuse Rating	25A

PACKAGING CONFIGURATION	
	40 FT (HQ)
Number of Modules Per Container	720
Number of Modules Per Pallet	36
Number of Pallets Per Container	20

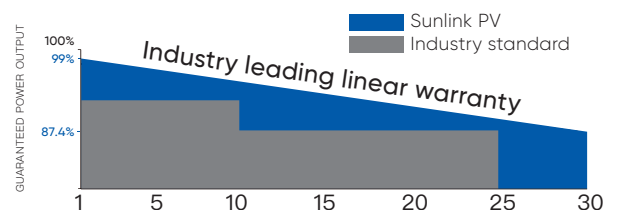
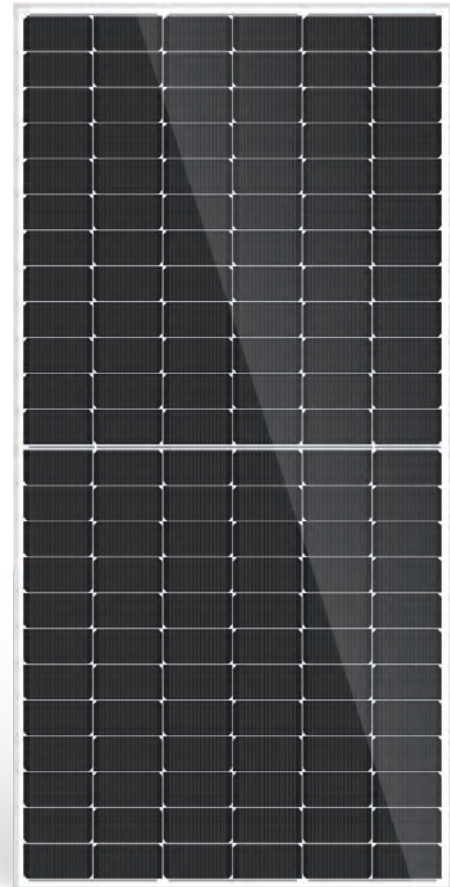

25 years product warranty | 30 years linear performance warranty

TOPCON BIFACIAL MODULE

SL5N144 | 570 WATT

BACK OVERVIEW

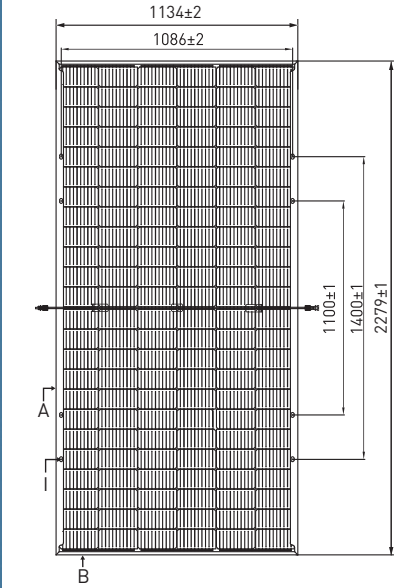

DRAWINGS (MM)

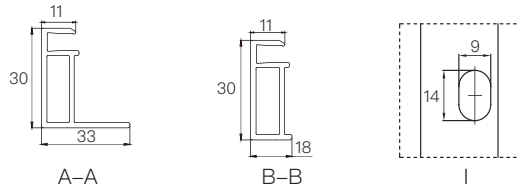

CURRENT-VOLTAGE & POWER-VOLTAGE CURVES (SL5N144)

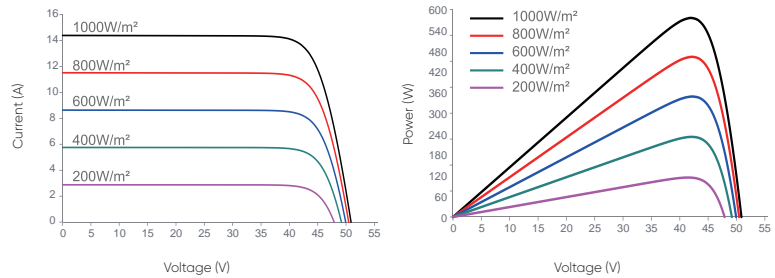

HIGH LIGHTS

$$+ \frac{W}{m^2}$$

HIGHER EFFICIENCY

- Module efficiency high to 22.06% ensure less BOS cost
- Gain more solar power per square meter

$$\frac{25}{30}$$

LONGER WARRANTY

- N-type TOPCON technology ensures 25-year product warranty and 30-year power warranty

$$\leq 1\%$$

$$\leq 0.4\%$$

LESS DEGRADATION

- 1st year degradation < 1%
- Annual degradation < 0.4%

$$\geq 75\%$$

HIGHER BIFACIALITY

- 75%-80% Bifaciality ensures to gain more solar energy from backside

$$\frac{\%}{^{\circ}C}$$

$$-0.3$$

LOWER TEMPERATURE COEFFICIENT OF PMAX

- TOPCON modules' coefficient of Pmax low to -0.3%/C helps gaining more power at sunny days.



FIRE SAFETY CLASS

- Class A According to IEC 61730-2 MST23(UL 790)